

# L K HOIST

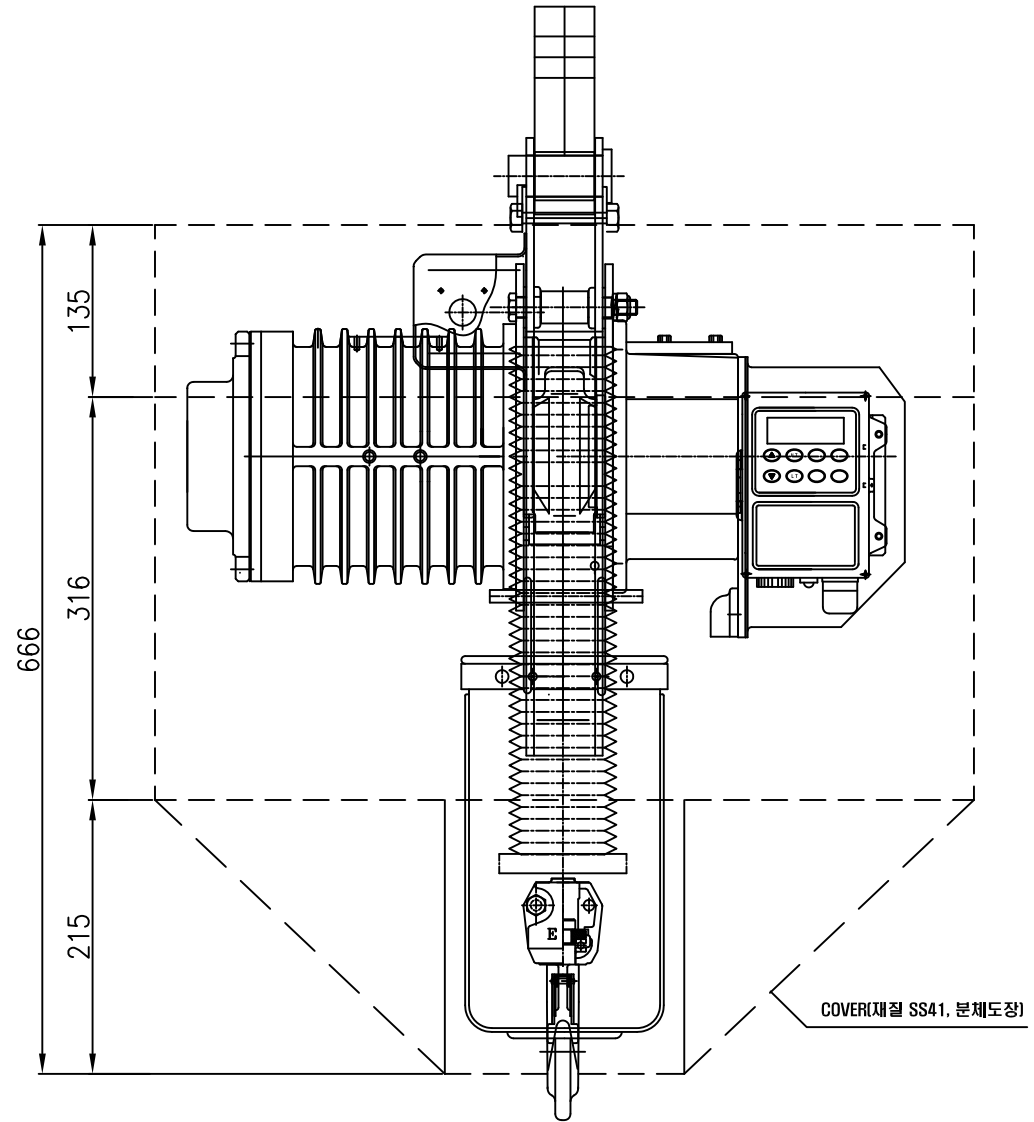
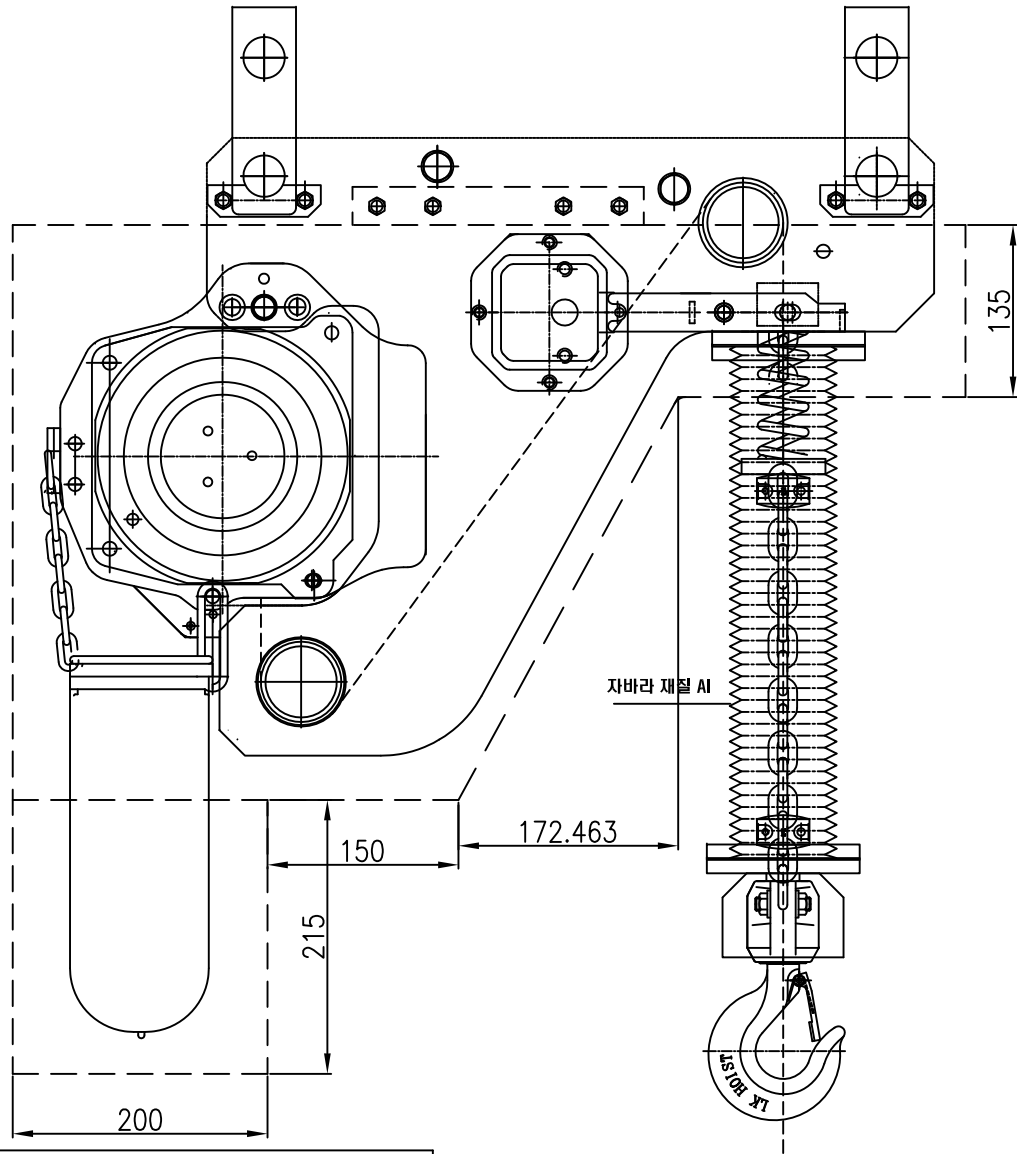

## SPECIFICATION

RATED LOAD	1	TON
TESTING LOAD	1.25	TON
LIFTING HEIGHT	4.5	M
HOISTING	SPEED	8.2 M/MIN
	MOTOR	1.8 KW x 1 SET
TRAVERSING	SPEED	- M/MIN
	MOTOR	- KW x - SET
POWER SUPPLY	AC220,380,440,460,480Vx3φx60 Hz	
OPERATING METHOD	P.B type ON . FL	
WEIGHT	185KG	

## \* NOTE

- 특이사항: 1)HOIST 제작시 다소의 치수변경 치수변경 될수있음  
 2)자바라는 직경  $\phi 100$  사용 구입은 구로 영업소 통해구입  
 3)소요량은 7개구입 하여 사용

TITLE SFDA-1S ELECTRIC CHAIN HOIST				PROJECTION	
WORK NO		WORK NAME		SCALE Q' TY	
6				N S 1	
DRAWN	CHECKED	REVIEWED	APPROVED	DRAWING NO	
김창기					
2006.11.07					